

# REMINGTON®



PF7855

## Use and Care Guide

Product may vary slightly from what is illustrated.

### Register Your New Product Today!

By registering your new Remington® product, you will receive special offers.  
Register online at: [RemingtonProducts.com](http://RemingtonProducts.com)

## IMPORTANT SAFETY INSTRUCTIONS

When using an electrical appliance, basic precautions should always be observed, including the following. **Read all instructions before using this shaver.**

### DANGER

#### To reduce the risk of electric shock:

- Do not reach for an appliance that has fallen into water. Unplug it immediately.
- Do not use a plugged in appliance while bathing or in the shower.
- Model PF7855 can be used wet or dry. The shaver can be used in the shower and rinsed under the faucet for cleaning.
- Do not place or store this appliance where it can fall or be pulled into a tub or sink. Do not place or drop into water or other liquid.
- Except when charging, always unplug this appliance from the electrical outlet immediately after using.
- Detach the appliance from the power supply cord before cleaning.

### WARNING

#### To reduce the risk of burns, fire, electric shock, or injury to persons:

- An appliance should never be left unattended when it's plugged in, except when charging a rechargeable appliance.
- Close supervision is necessary when this appliance is used by, on, or near children, or individuals with special needs or certain disabilities.
- Use this appliance only for its intended use as described in this manual. Do not use attachments not recommended by the manufacturer.
- Never operate this appliance if it has a damaged cord or plug or if it is not working properly, if it has been dropped or damaged, or if it has been dropped into water.
- Keep the cord away from heated surfaces.
- Never drop or insert any object into any of the appliance's openings.

- Household use only.
- Do not use outdoors or operate where aerosol (spray) products are being used or where oxygen is being administered.
- Always attach the plug to the appliance, then to outlet. To disconnect, turn all controls to OFF, then remove plug from outlet.
- Always pull on cord plug to unplug from wall socket. Never pull on electric cord.
- Do not plug or unplug this appliance when your hands are wet.
- Do not use an extension cord or a voltage converter with this appliance.
- Do not wrap the cord around the appliance.
- Always store this appliance and cord in a moisture-free area. Do not store it in temperatures exceeding 140°F (60°C).
- Detach removable power cords from appliance for storage.
- Do not use this appliance with a damaged or broken head or cutters, as facial injury may occur.
- Shavers, including the trimmer, are for use on facial hair only. They should not be used for shaving the hair on your head or any other part of your body.

## SAVE THESE INSTRUCTIONS

### Product Features



#### Shaver Parts

1. On/Off button
2. Foils
3. Cutter assembly
4. Intercept trimmer
5. Hairpocket
6. Charging indicator
7. Power port
8. Pop-up trimmer
9. Pop-up trimmer button
10. Stubble attachment/Head guard
11. Cleaning brush
12. Power adapter (not shown)

### About Your Shaver

FEATURE	PF7855
INTERCEPT TRIMMER	Yes
PIVOT	Yes
POWER SYSTEM	Cordless/Rechargeable
BATTERY TYPE	NiMH
FULL CHARGE TIME	2 hours
CORDLESS SHAVE TIME	Up to 60 minutes
5 MIN. QUICK CHARGE	Yes
INDICATORS	1 LED
WATER RESISTANCE	Wet/Dry
VOLTAGE	Worldwide
REPLACEMENT PART NO.	SPF-PF

**Intercept Trimmer** - trims longer hairs so they can easily enter foils to shave close.

**Pivot** - Shaver head pivots to adjust to any angle on the face.

**Cordless/Rechargeable** - shaver can only be used without the power cord.

**Quick Charge** - Shaver will charge long enough for one shave in 5 minutes.

#### Water Resistance

**Wet/Dry** - Shaver can be used in the shower and with shaving gels. Can be cleaned by rinsing under running water.

#### Indicators

**LED** - Flashing green light indicates battery needs to be charged. Solid green light will turn on when charging and turn off when full charge reached.

**Worldwide Voltage** - shaver automatically adapts to an outlet voltage between 100V and 240V.

### Charging

Before using, read the important safety instructions in front of the manual.

1. Connect the cord to the shaver and then to the electrical outlet. (Diagrams A & B) The charging indicator light will glow green.
2. Your shaver will have a partially charged battery. We recommend giving the battery a full charge prior to your first use.

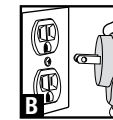
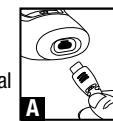

Use the product until the battery is low. To preserve the life of the batteries, let them fully run out every six months, then give the battery a full charge. **CAUTION!**

- Make sure the shaver and your hands are dry when placing the shaver on charge.
- Always charge the shaver in a cool, dry place.

### Shave

Before using, read the important safety instructions in front of the manual.

1. Begin by removing the Stubble comb/Head guard from your shaver.
2. Press the on/off button to turn on. (Diagram D)
3. Stretch the skin with your free hand so the hairs stand upright.
4. Hold the shaving head so all screens touch your skin

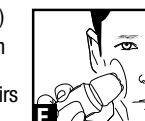

simultaneously. The independently floating foils automatically adjust to the contours of your face. Only apply light pressure on the shaving head while shaving and use short, circular strokes. (Diagram E)

5. After shaving, turn the shaver off. (Diagram D)

**Remington recommends that you use your new shaver daily for up to three weeks to allow time for your hair and skin to become accustomed to the new shaving system.**

### Shaving Tips (Dry)

- Ensure your skin is dry and free of oils.
- Wait at least 15 minutes after getting up before shaving, to ensure your face is free of puffiness that may be present from sleeping.
- Always hold the shaver at a right angle to the skin so the screens are touching the skin with equal pressure.
- Stretch skin with the free hand so hairs stand upright, making it easier for them to enter the cutting chamber.
- Shave with short, circular strokes. The use of short, circular motions in stubborn areas may obtain a closer shave, especially along the neck and chin line.
- Do not press hard against the skin in order to avoid damage to the foil heads.

**NOTE:** To achieve a stubble look instead of a clean shave, affix the Stubble comb/Head guard over the cutter assembly and shave as usual.

### Shaving Tips With Gel or Foam (In Shower or Over the Sink)

All models can be used in the shower for optimal performance.

**NOTE:** In order to ensure optimal performance, thoroughly rinse the shaver head under water during and after shaving.

1. Apply water to face and neck area.
2. Apply shave gel or foam to applicable shaving area.
3. Rinse shaver head under water.
4. Shave face and neck using short, circular strokes.
5. Throughout the shave, regularly rinse shaver head under water to avoid residue build up.
6. When finished shaving, rinse face.
7. Thoroughly rinse shaver head of all gel or foam.
8. Follow cleaning and care instruction.

## Trim

1. Slide trimmer release button up to engage the trimmer. (Diagram F)
2. Trim long, difficult hairs and side burns. (Diagram G)
3. Close trimmer by sliding the button down. (Diagram H)

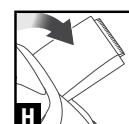
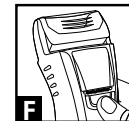

## Cleaning and Care



The shaver is a wet/dry appliance. The shaver may be cleaned under warm water.

- Do not remove or replace head assembly while shaver is running as it may cause damage to the unit's foils and cutters.
- To clean the external surfaces of the shaver, use a damp cloth. Do not use strong detergents or other chemicals.
- To dry, wipe the surface of the shaver with a dry towel. Do not use a hair dryer or heater to dry the shaver.
- The shaver should not be used until it has dried.
- Lubricate each cutter with household oil.
- This product contains no user serviceable parts.

**NOTE:** When cleaning your shaver, make sure the shaver is turned off and disconnected from the power adapter.

For optimal shaver performance, clean your shaver after each use.

### CAUTION!

- Shaver can be placed under running water for cleaning only. Never submerge the shaver in water.

### Daily Cleaning:

1. Pull off Stubble comb/Head guard, if using, and rinse attachment.
2. Grasp the front and back of the cutter assembly and pull away from the shaver body. (Diagram I)
3. Tap the stubble from the foils and cutters.
4. Use the cleaning brush to sweep any loose hairs from the cutters, hairpocket, and trimmer. Pay close attention to cleaning out the corners and crevices inside the hairpocket. (Diagrams J–K)
5. Rinse head under running water.
6. Gently dry with towel or leave disassembled to air dry.
7. Replace hair pocket assembly when dry. (Diagram L)
8. Reattach the Stubble comb/Head guard to protect the shaving head until next use.

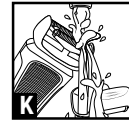
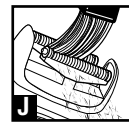

### Monthly Cleaning:

1. Perform the daily cleaning steps 1-4.
2. Place a drop of liquid soap on each cutter and in the hairpocket. (Diagram M)
3. Brush the soap around vigorously with the supplied cleaning brush. Be sure to work the soap into the corners of the hairpocket and into any especially dirty cutters. (Diagram N)
4. Add a small amount of water to the cutters.
5. Replace the foil assembly. (Diagram O)
6. Turn on the shaver for approximately 30 seconds.
7. While the shaver is running, rinse the foils under running water. (Diagram P)
8. Turn off shaver.
9. Remove foil assembly.
10. Rinse the cutters, hairpocket, and foil assembly thoroughly. (Diagram Q)
11. Shake off excess water.
12. Replace foil assembly. (Diagram R)
13. Allow shaver to dry before next use and attach the Stubble comb/Head guard.

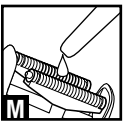

## Product Disposal

When your rechargeable shaver reaches the end of its useful life, the batteries must be removed from the shaver and recycled or disposed of properly in accordance with your state and local requirements. If this is not required by law, you may elect to dispose of the shaver with the batteries.

This device uses one of the following types of rechargeable batteries: nickel metal hydride (NiMH), nickel cadmium (Ni-Cd) or Lithium Ion (Li-Ion) (see included battery for indication of type).

**CAUTION: ALL RECHARGEABLE BATTERIES MUST BE RECYCLED OR DISPOSED OF IN ACCORDANCE WITH APPLICABLE STATE AND LOCAL REGULATIONS. DO NOT PUT IN FIRE OR MUTILATE, AS THE BATTERY MAY BURST OR RELEASE TOXIC MATERIALS. DO NOT SHORT-CIRCUIT, AS THIS MAY CAUSE BURNS.**

The RBRC® program provides a convenient alternative to placing used batteries into the trash or the municipal waste stream, which may be illegal in your area. Please call 1-800-8-BATTERYTM or visit [www.call2recycle.org](http://www.call2recycle.org) for information on LiFePO4 battery recycling and disposal bans/restriction in your area. Spectrum Brands, Inc.'s involvement in this program is part of our commitment to preserving our environment and conserving our natural resources.

### To Remove the Rechargeable Battery:

1. Remove Phillips head screw at the base of the shaver.
2. Pry the outer sleeve down off the shaver handle.
3. Pry the back housing cover off the shaver.
4. Remove screws from inner housing and open inner housing to expose the batteries.
5. Snip the battery wires and remove batteries.
6. Dispose of battery properly.

Spectrum Brands, Inc. is a proud participant in the EPA-approved Rechargeable Battery Recycling Call2Recycle™, which collects and recycles these batteries at the end of their useful life when taken out of service in the United States.

## Power Adaptor

## IMPORTANT SAFETY INSTRUCTIONS - SAVE THESE INSTRUCTIONS

## DANGER - TO REDUCE THE RISK OF FIRE OR ELECTRIC SHOCK, CAREFULLY FOLLOW THESE INSTRUCTIONS

For connection to a power supply not in the U.S.A., use an attachment plug adapter of the proper configuration for the power outlet.

## How to Order Shaver Accessories

Please refer to the shaver comparison and features chart near the front of this manual that lists the correct replacement part number for your shaver.

It is very important to replace your head and cutters when necessary to ensure a close, comfortable shave without irritation. We recommend they be replaced every 12 months. Here are some signs of head and cutter wear, indicating that replacement is needed:

- **Irritation:** As the heads get excessively worn you may experience some skin irritation. This would be especially noticeable when you apply moisturizing lotion.
- **Pulling:** When the cutters wear you may feel a sense of pulling and a loss of closeness when you shave. This is an indication that it is time to replace your heads and cutters.

**Maintain your shaver's peak performance! Keep your shaver performing like new!**

- Because your satisfaction is important to us, we want to make it simple for you to keep your new shaver performing at its peak.
- For the best possible shave, it is necessary to replace the heads and cutters on your shaver every 12 months.
- Remington makes this easy!

### Two easy ways to order!

1. Call! U.S. residents call 800-392-6544
2. Order Online at [RemingtonProducts.com](http://RemingtonProducts.com)

## Warranty

### Lifetime Warranty

Spectrum Brands, Inc. warrants this product against any defects that are due to faulty material or workmanship for the life of the product. This warranty does not include damage to the product resulting from accident or misuse.

If the product should become defective, we will replace it free of charge. Return your product with your name, address and day time phone number to: Remington Returns Center, 507 Stokely Dr., P.O. Box 1, Deforest, WI 53532. For more information call 800-736-4648 in the US or 800-268-0425 in Canada.

### Warranty excludes:

- The heads and cutters are not included in lifetime warranty

### This warranty does not cover products damaged by the following:

- Accident, misuse, abuse or alteration of the product
- Servicing by unauthorized persons
- Use with unauthorized accessories
- Connecting it to incorrect current and voltage
- Wrapping cord around appliance causing premature wear & breakage
- Any other conditions beyond our control

No responsibility, obligation, or liability is assumed for the installation or maintenance of this product.

**SPECTRUM BRANDS, INC. SHALL NOT BE RESPONSIBLE FOR ANY INCIDENTAL, SPECIAL OR CONSEQUENTIAL DAMAGES RESULTING FROM THE USE OF THIS PRODUCT. ALL IMPLIED WARRANTIES, INCLUDING BUT NOT LIMITED TO IMPLIED WARRANTIES OF FITNESS AND MERCHANTABILITY, ARE LIMITED IN DURATION TO THE LIFE OF THE PRODUCT.**

This warranty gives you specific legal rights and you may also have other rights which vary from state to state or province to province. Some states do not allow the exclusion or limitation of incidental, special or consequential damages.

**This warranty shall not be valid where it is contrary to U.S. and other applicable laws, or where the warranty would be prohibited under any economic sanctions, export control laws, embargos, or other restrictive trade mea-**

**asures enforced by the United States or other applicable jurisdictions. This includes, without limitation, any warranty claims implicating parties from, or otherwise located in, Cuba, Iran, North Korea, Syria and the disputed Crimea region.**

### Spectrum Brands, Inc. Money-back Offer

If within 30 days after you have purchased your Remington branded product, you are not satisfied and would like a refund, return it with the sales slip indicating purchase price and date of purchase to the retailer from whom it was purchased. Spectrum Brands, Inc. will reimburse all retailers who accept the product within 30 days from the date of purchase. If you have any questions concerning the money-back guarantee, please call 800-736-4648 in the US.

### Remington 60-Day Money Back Guarantee\*

If within 60 days after purchasing any Remington branded product, you are not completely satisfied and would like a refund, return it with the original dated sales receipt directly to Remington and receive a full refund.\*\* For questions concerning the money-back guarantee, please call 800-736-4648 in the US.

\*Applies to US and Canadian customers' returns only.

\*\*Terms and conditions apply.

### Terms and Conditions

1. Refund will be in the form of a check issued in US Dollars and will be provided only if all Terms and Conditions are met.
2. The following items must be returned to Remington and postmarked no later than 60 days after purchase of the Remington branded Men's Shave and Groom product:
  - a. The Remington product;
  - b. The original sales receipt indicating price and date purchased; and
  - c. The completed 60-day money back guarantee form located at [RemingtonProducts.com/60day](http://RemingtonProducts.com/60day).
3. In addition, Remington, in its discretion, must determine that the returned product was used in accordance with the instruction booklet (included with the product at the time of purchase).
4. Returns should be mailed prepaid (no collect returns accepted) to:  
Remington 60-Day MBG  
507 Stokely Drive, Box 1  
DeForest, WI 53532
5. Refund does not include postage costs for the return of the product, but will include applicable taxes paid by customer, if any.

6. No responsibility will be accepted for late, lost, stolen, misdirected or damaged product.
7. Please allow 4-6 weeks to receive your refund by check.  
**Questions or comments:** Call 800-736-4648 in the U.S. or visit [RemingtonProducts.com](http://RemingtonProducts.com).

100-240 VAC, 50/60 Hz

TYPE: F20A

**Questions or comments:**

Call 800-736-4648 in the U.S. or visit [RemingtonProducts.com](http://RemingtonProducts.com)

Dist. by: Spectrum Brands, Inc., Middleton, WI 53562

REMINGTON is a Registered Trademark of Spectrum Brands, Inc.

© 2019 Spectrum Brands, Inc. 8/19

26158

Made in China.

T22-7001219-A

Contains a listed adapter